

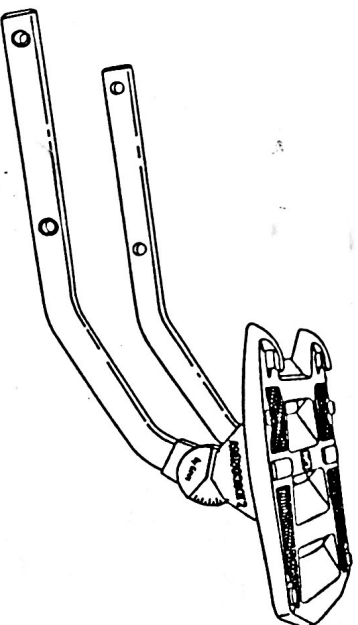

# HONDA ART. F 209

CBX 650 SC

ISTRUZIONI DI MONTAGGIO  
MOUNTING INSTRUCTIONS

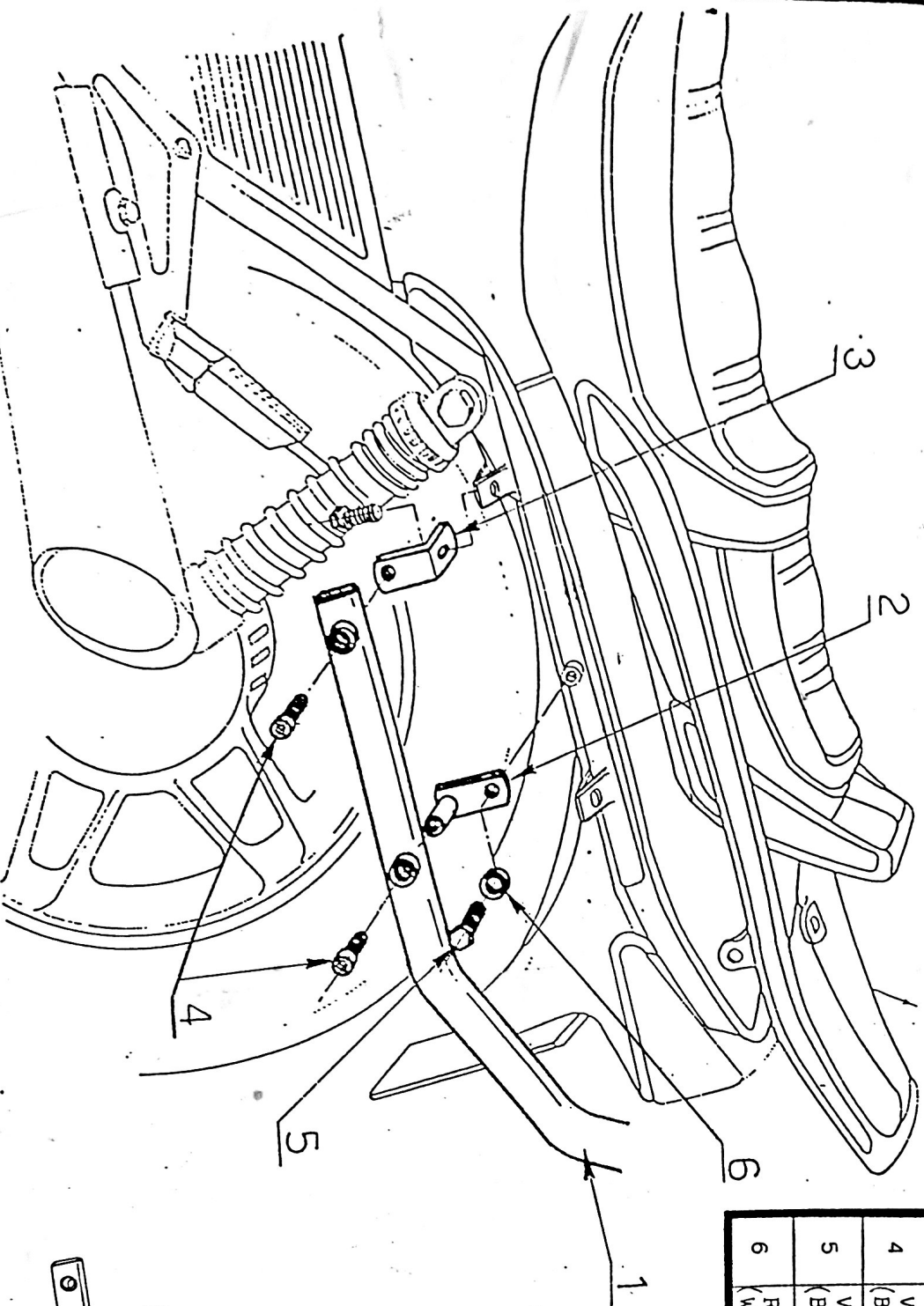

N°	DESCRIZIONE DEL KIT (KIT DESCRIPTION)	QUANTITA' (QUANTITY)
1	MONORACK CIVI	
2	SUPPORTO (SUPPORT)	2
3	SUPPORTO A L (L SUPPORT)	2
4	VITE M 8 X 20 TCEI (BOLT M 8 X 20)	4
5	VITE M 8 X 16 TE (BOLT M 8 X 16)	2
6	RONDELLA Ø 8 (WASHER Ø 8)	2

# FISSAGGIO - REGOLAZIONE PIASTRE E SNODI FIXING - ADJUSTMENT PLATES AND JOINTS MONORACK

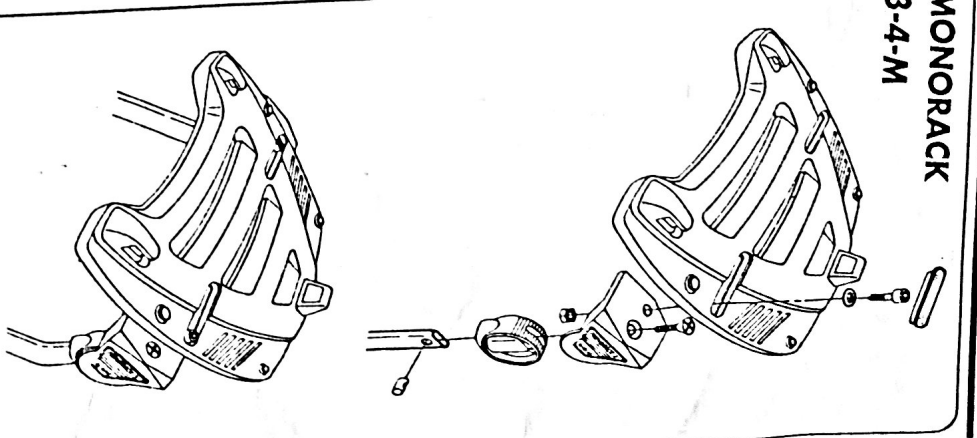
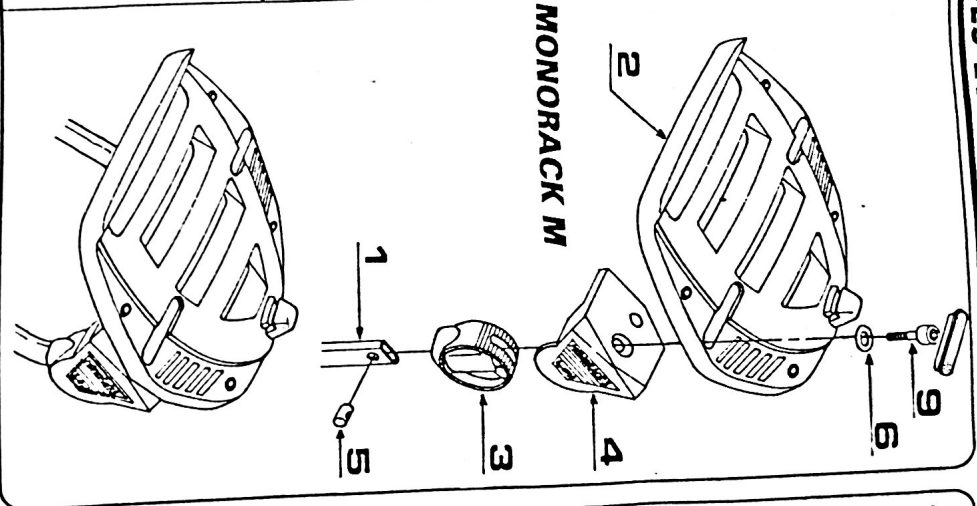
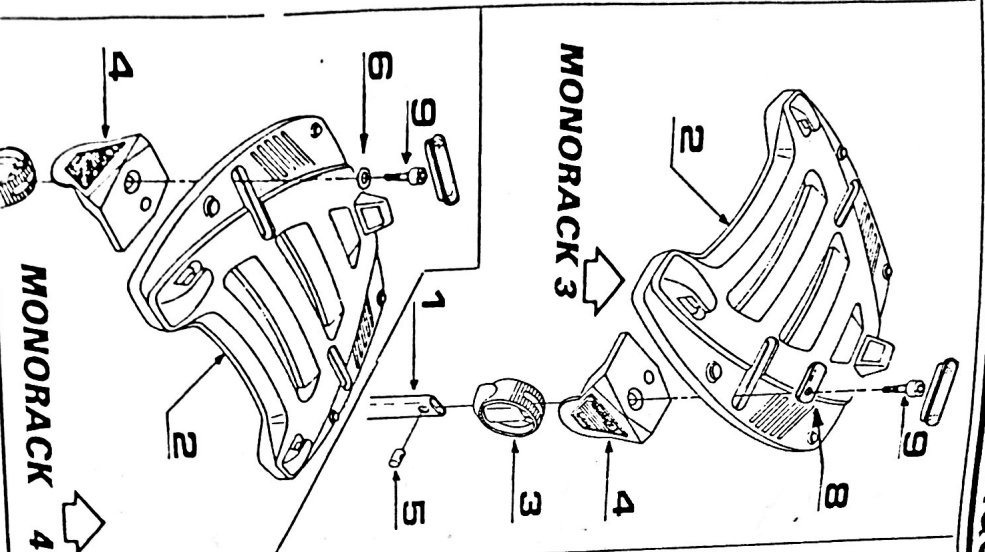
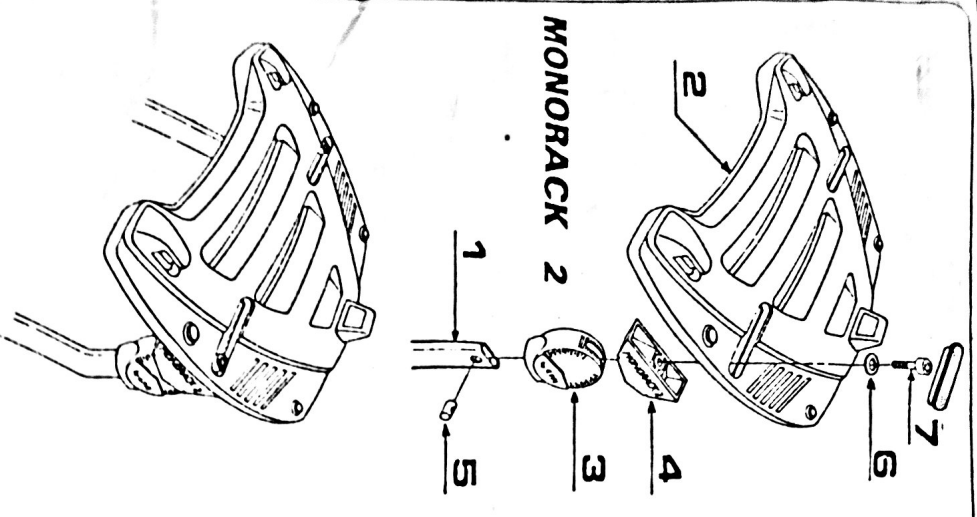

**PER AVERE UNA GIUSTA REGOLAZIONE DELLA PIASTRA I DUE CAVALLOTTI DEGU SNODI DEVONO AVERE LA STESSA INCLINAZIONE.**  
**TO HAVE A RIGHT ADJUSTMENT OF THE PLATE THE TWO CONNECTION RODS MUST HAVE THE SAME INCLINATION.**  
**POUR AVOIR UN BON REGLAGE DE LA PLAQUE LES DEUX CRAMPILONS DOIVENT AVOIR LA MEME INCLINATION.**

N°	DESCRIZIONE DEL KIT KIT DESCRIPTION DU KIT	QUANTITÀ QUANTITE	5	BUSSOLA AXLE BOX BOUSSOLE	2
1	MONORACK GVI	2	6	RONDELLA Ø 8 X 14 WASHER Ø 8 X 14 RONDELLE Ø 8 X 14	2
2	PIASTRA PLAQUE	1	7	VITE TCEI M 8 X 55 SCREW M 8 X 55 VIS M 8 X 55	2
3	SNODO JOINT ROTULE	2	8	PIASTRINA LITTLE PLATE PETITE PLAQUE	2
4	CAVALLOTTO "U" BOLT CRAMPILLON	2	9	VITE TCEI M 8 X 60 SCREW M 8 X 60 VIS M 8 X 60	2

**REGOLAZIONE MASSIMA  
(POSSIBILE SOLO CON SNODI  
MONORACK 3 E 4)**

**MAXIMUM ADJUSTMENT  
(ONLY POSSIBLE WITH JOINTS  
MONORACK 3 AND 4)**

**REGLAGE MAXIMUM  
(POSSIBLE UNIQUEMENT  
AVEC PLAQUE ET ROTULES  
MONORACK 3 ET 4)**